

HM Tastspitzen  
stylus tips

HM Kegeltastspitzen  
cone stylus tips

9031896  
OV2001-2301  
∅3,5/L=82,5  
/12°/25µm

6851517  
03.081-2029  
∅3,5/L=59,5  
/12°/25µm \*

6850286  
03.081-2029  
∅3,5/L=33  
/12°/25µm \*

6850289  
03.081-2029  
∅3,5/L=20,5  
/12°/25µm \*

9027627  
FC3093-0100  
∅3,5/L=12,5  
/19°/25µm

6851523  
PS0515-0000  
∅3,5/L=33  
/30°/25µm \*

6851534  
FC3003-0000  
∅3,5/L=33  
/24°/25µm \*



Nicht für M-Tastarme  
not for m-probearms

Querarm  
traverse arm

6851513  
PO0103-0055  
für Taststift  
∅ 3,5

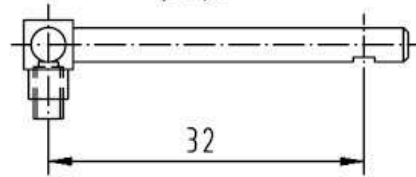

HM Doppeltastspitze  
double stylus tip

Tastspitzen mit Kugel  
stylus tips with ball

HM Tastschneiden gerade  
stylus tips with blade

Schneidenbreite 3 mm

6851530  
OV2001-2005  
∅3,5/L=18  
/19°/25µm

9014281  
FC3007-0001  
∅3,5/L=59,5  
HM ∅1,0

9036744  
OV2001-2324  
∅3,5/L=33  
Rubin ∅0,5

9032397  
OV2001-2318  
∅3,5/L=13  
Rubin ∅1,0

9030992  
FC3108-1000  
∅3,5/L=20,5  
/20°/25µm

6851532  
FC3046-0000  
∅3,5/L=33  
/12°/25µm

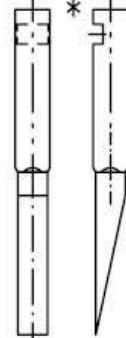
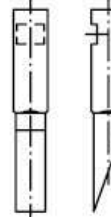
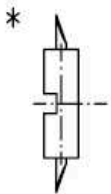

Nur für M-Tastarme  
only for m-probe arms  
6851529 + 9032280

Tastspitzen/-schneiden u. Querarm  
M 1,5 : 1

\* Standard Tastspitze  
standard stylus